

ABANDONED OR INACTIVE URANIUM
MINES IN NEW MEXICO

A report of investigation carried out
between August 1979 and May 1980 under
contract with the New Mexico Energy and
Minerals Department.

by

Orin J. Anderson

New Mexico Bureau of Mines and
Mineral Resources
Open-File Report 148

INTRODUCTION

During the course of this investigation approximately 200 uranium mine sites were visited. Although these sites are distributed throughout 20 counties the majority are in McKinley, San Juan, and Valencia Counties, along the western and southern margin of the San Juan Basin. Other counties with an appreciable number of sites are Grant, Rio Arriba, Sandoval, Sierra, and Socorro.

Field work commenced in August, 1979 and extended although not continuously, into May, 1980. Information obtained during the on-site visits included location, type and size of mine, condition of mine, host formation, dimensions of remaining structures, proximity to residences or villages, water quality data, and radiation levels, although a gamma ray scintillometer was not obtained for the project until October 20, 1979. An effort was made to contact landowners whenever and wherever possible, however, no systematic attempt was made to determine land and mineral ownership during this phase of the investigation.

Mine operation data has been included where available. This consists of information on ore grades, production history mineralogy, and mine operator. Old publications of the U.S. AEC and the State Mine Inspectors office were helpful in this area.

The mine reports are arranged alphabetically by county with each county having its own index. A NM- or AZ-mine identification number is given with each mine name in the index. It is an AML numbering system devised by Don Baker, Jr. The first part of this

identification number is based on a U.S. Soil Conservation Service numbering system of 15' quadrangles beginning with 1 in the northwest corner of the state to 24 in the northeast corner, then returning to the western border to start a new tier. The second part refers to a 7½' quad within the 15' quad; these are numbered counterclockwise from 1 in the NE quadrant to 4 in the SE. The last part of the number refers to a particular mine within the 7½' quad. An AZ- prefix indicates the 15' quadrangle is an Arizona quad that overlaps the New Mexico state boundary.

Acknowledgments - The writer wishes to thank the following people for their valuable assistance in the field: Lars (Skip) Skotte, Richard Chamberlin, JoAnne Osburn, Mary Ann Anderson, and Cheryl Kyllonen.

A special thanks is extended to Mr. William Chenoweth of the U.S. Department of Energy, both for his time in the field as well as the claim maps and A.E.C. mine production records he provided. Mr. John Blagbrough provided helpful information about the Chuska district. The editorial assistance of Wyatt Brewster and Lars (Skip) Skotte is gratefully acknowledged.

The help and cooperation of the Navajo Tribe Office in Window Rock, Arizona permitted a statewide investigation to be completed; a note of thanks goes to Mr. R. Zaman and Mr. William Armstrong of that office.

Quad: Redrock Valley 15'

1. AZ-40-0-1
VCA Plot #7 (Lower Oak Creek)
Page ~~41~~ 42
2. AZ-40-0-2
Franks Point (Plot. 6)
Page ~~53~~ 54
3. AZ-40-0-3
Lower Salt Rock
AZ-40-0-3
Upper Salt Rock
Page ~~56~~ 57
4. AZ-40-0-4
Williams Point (Plot #4)
Page ~~64~~ 65
5. AZ-40-0-5
Salt Canyon Mines (Salt Canyon Claim)
Page ~~68~~ 69
- 6-9. AZ-40-0-6 to 9
VCA Plot #3
Page ~~73~~ 76
10. AZ-40-0-10
Tent (Tent Claim)
Page ~~90~~ 91
11. AZ-40-0-11
Begay Incline
Page ~~93~~ 94
12. AZ-40-0-12
Begay #2
Page ~~97~~ 98
13. AZ-40-0-13
Carrizo #1 (MP-24)
Page ~~100~~ 101
14. AZ-40-0-14
King Tutt Point (VCA Plot #2)
Page ~~104~~ 105
15. AZ-40-0-15
Begay (Begay #1)
Page ~~111~~ 113

- | | |
|-------------------------------------|-------------------------|
| 16. AZ-40-0-16 | Page 115 118 |
| Red Wash Point (VCA Plot #1) | |
| 17. AZ-40-0-17 | Page 119 122 |
| King Tutt 1 (MPG) | |
| 18. AZ-40-0-18 | Page 125 128 |
| Junction | |
| 19. AZ-40-0-19 | Page 128 131 |
| Alongo (Alongo Claim) | |
| 20. AZ-40-0-20 | Page 131 134 |
| Canyon View (Alongo Claim) | |
| 21. AZ-40-0-21 | Page 135 138 |
| KING Tutt #2 (MP-G Sylvania Mining) | |

REFERENCES FOR CARRIZO MINING DISTRICT

- | | |
|--|-------------------------|
| *Preface to Chuska District Reports | Page 138 141 |
| *Road log to Sanostee Quad. and the Chuska Mining District | Page 141 144 |

Quad: Sanostee West 7½'

- | | |
|---------------------------|----------|
| 1. NM-49-2-1 | Page 148 |
| Dennet Nezz #1 and #2 | |
| 2. NM-49-2-2 | Page 150 |
| Dennet Nezz #3 | |
| 3. NM-49-2-1001 (unnamed) | Page 151 |
| (unnamed) Sec. 8 Adit | |

PREFACE TO EAST CARRIZO DISTRICT REPORTS

The East Carrizo District lies along or within several miles of the Arizona border in townships 29 and 30 N., and ranges 20 and 21 west.

The area is covered on the Pastora Peak and Redrock Valley 15' topographic quadrangles, but is largely unsurveyed. A land net was projected in solely to determine if our locations agreed with those given in other publications such as Hilpert, L., (1969), and does not appear on the East Carrizo District claim maps (after AEC, 1953, Claim Maps, East Carrizo District) that accompany each report.

These claim maps were provided for our use on this project by Mr. William Chenoweth of the U.S. Department of Energy, Grand Junction Office, Grand Junction, Colorado. They show access roads, drainage lines, and the claims in the area as of 1953. The only scale they carry is the mile post markers along the New Mexico/Arizona state line.

Orin J. Anderson

*New Mexico Bureau of Mines and Mineral Resources
Socorro, New Mexico
June, 1980*

Date Visited 11/2/79

Mine name(s) Begay Incline

County San Juan

Section (Unsurveyed) NE $\frac{1}{4}$ 24

Twsh. 29 N

R. 21 W

Quadrangle sheet Redrock Valley 15'

Mining district East Carrizo

Elevation 5550'

Nearest city and/or dwelling 2 mi. SE of Oak Springs

The Begay Incline is located on an ENE trending ridge at the confluence of Red and Oak Spring Washes. Access is via dirt road eastward from the Oak Spring/Red Rock road. The dirt road runs ENE towards Red Wash Point, between Horse Mesa and the state line mile marker number 20 (see claim map for roads and location).

Workings consist of a single incline. The entrance is partially caved and untimbered (Photo a). The opening at the surface is 20' x 35', with the internal dimensions of the decline being 6' wide, 8 feet high, and at least 60' deep (Photo b). The decline has a slope of approximately 12 degrees. Directly south of the decline is the dump (Photo c). It is 20' wide, 45' long, and 10' high.

The workings are driven into the Salt Wash Member of the Morrison Formation. No uranium minerals were visible, and scintillometer readings were relatively low. Maximum readings of 200 cps were found 50' into the decline, and 300 cps. were recorded on the dump.

The Begay Incline was operated by the Texas Mining Company in 1955 and 1956. A total of 655 tons of ore was mined, containing 3,475 pounds of U_3O_8 at an average grade of .27%, and 38,215 pounds of V_2O_5 , at an average grade of 2.92% (AEC prod. records).

- References:
- (1) Chenoweth, W.L., 1980, Historical Review of Uranium-Vanadium in The Eastern Carrizo Mountains, San Juan County, New Mexico, U.S. DOE, TM-210.
 - (2) Hilpert, L., 1969, Uranium Resources of NW New Mexico, U.S.G.S., pp. 603, p. 52.
 - (3) East Carrizo District Claim Index Map, 1953.

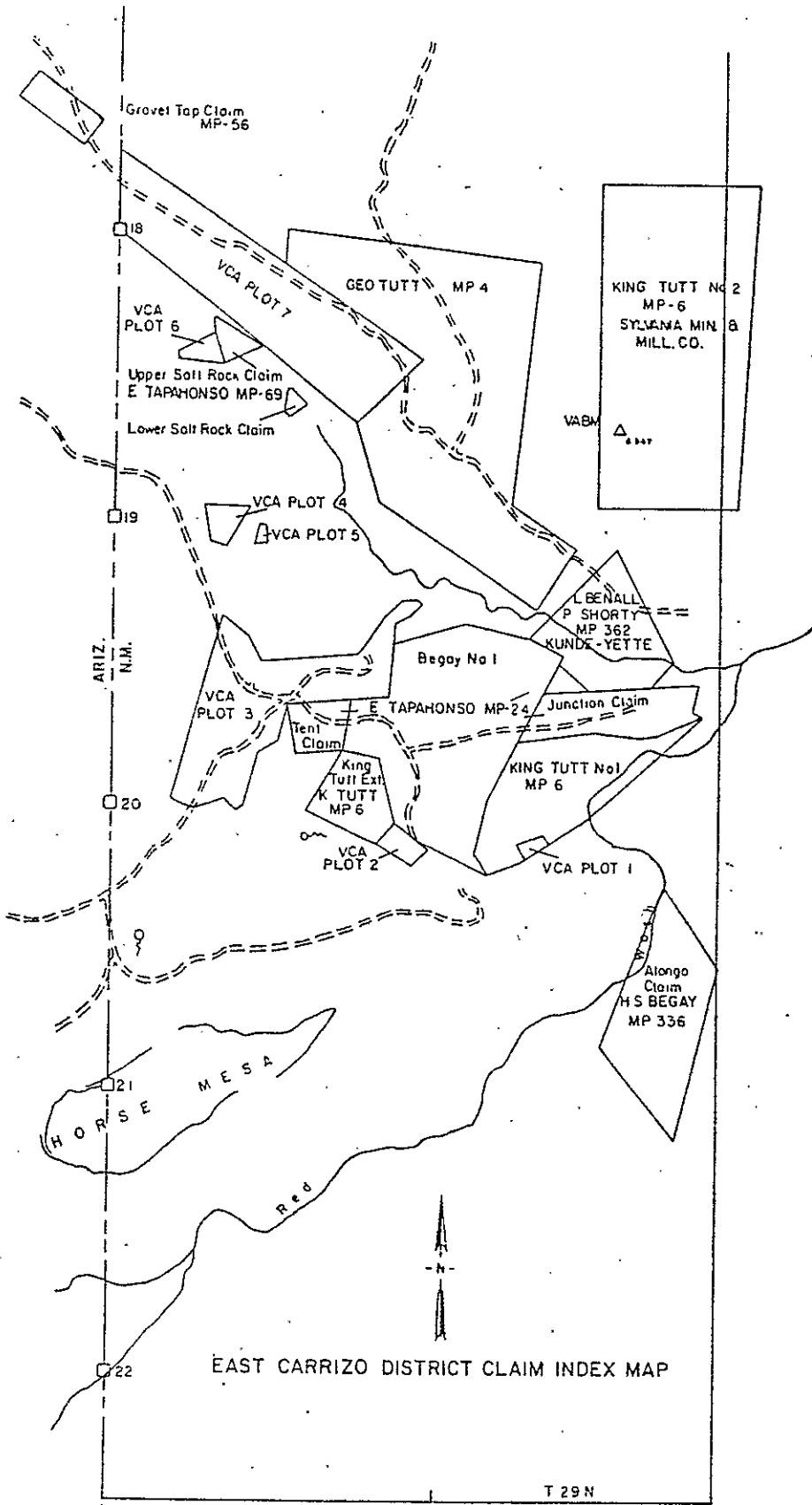

EAST CARRIZO DISTRICT CLAIM INDEX MAP

T 29 N
T 28 N



Photo A - looking north at entrance to Begay Incline. Note hammer on wooden post in foreground for scale.

510 SJ-96

Photo B - closeup of Begay
Incline. Note hammer
in foreground for
scale.

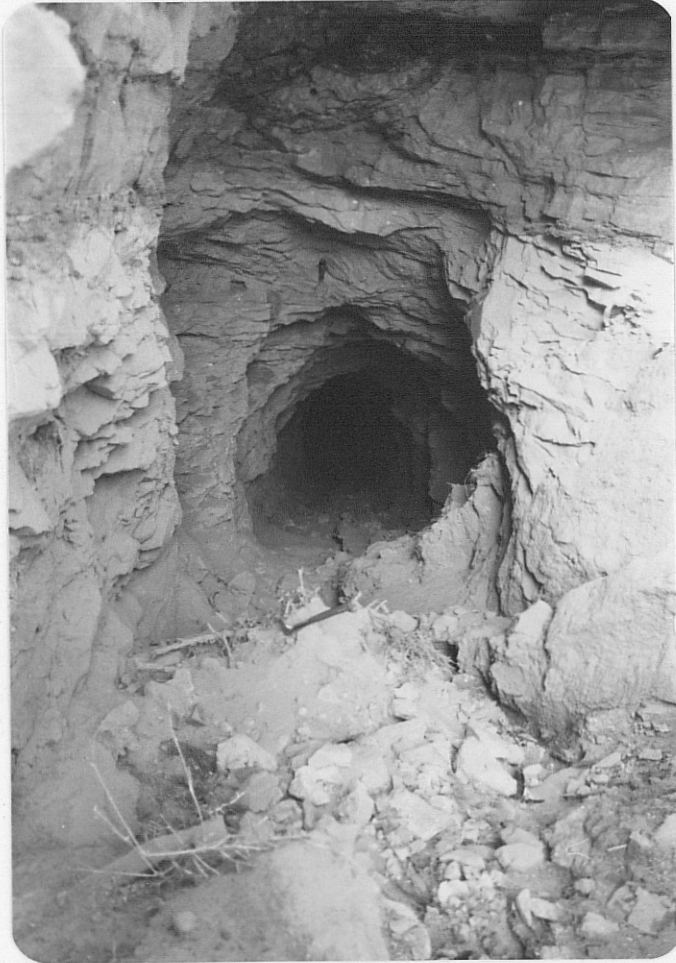

Photo C -
looking south
at Begay
Incline dump.
Small stump
(circled) on
top of dump
is 1 foot
long.

