

ABANDONED OR INACTIVE URANIUM
MINES IN NEW MEXICO

A report of investigation carried out
between August 1979 and May 1980 under
contract with the New Mexico Energy and
Minerals Department.

by

Orin J. Anderson

New Mexico Bureau of Mines and
Mineral Resources
Open-File Report 148

INTRODUCTION

During the course of this investigation approximately 200 uranium mine sites were visited. Although these sites are distributed throughout 20 counties the majority are in McKinley, San Juan, and Valencia Counties, along the western and southern margin of the San Juan Basin. Other counties with an appreciable number of sites are Grant, Rio Arriba, Sandoval, Sierra, and Socorro.

Field work commenced in August, 1979 and extended although not continuously, into May, 1980. Information obtained during the on-site visits included location, type and size of mine, condition of mine, host formation, dimensions of remaining structures, proximity to residences or villages, water quality data, and radiation levels, although a gamma ray scintillometer was not obtained for the project until October 20, 1979. An effort was made to contact landowners whenever and wherever possible, however, no systematic attempt was made to determine land and mineral ownership during this phase of the investigation.

Mine operation data has been included where available. This consists of information on ore grades, production history mineralogy, and mine operator. Old publications of the U.S. AEC and the State Mine Inspectors office were helpful in this area.

The mine reports are arranged alphabetically by county with each county having its own index. A NM- or AZ-mine identification number is given with each mine name in the index. It is an AML numbering system devised by Don Baker, Jr. The first part of this

identification number is based on a U.S. Soil Conservation Service numbering system of 15' quadrangles beginning with 1 in the northwest corner of the state to 24 in the northeast corner, then returning to the western border to start a new tier. The second part refers to a 7½' quad within the 15' quad; these are numbered counterclockwise from 1 in the NE quadrant to 4 in the SE. The last part of the number refers to a particular mine within the 7½' quad. An AZ- prefix indicates the 15' quadrangle is an Arizona quad that overlaps the New Mexico state boundary.

Acknowledgments - The writer wishes to thank the following people for their valuable assistance in the field: Lars (Skip) Skotte, Richard Chamberlin, JoAnne Osburn, Mary Ann Anderson, and Cheryl Kyllonen.

A special thanks is extended to Mr. William Chenoweth of the U.S. Department of Energy, both for his time in the field as well as the claim maps and A.E.C. mine production records he provided. Mr. John Blagbrough provided helpful information about the Chuska district. The editorial assistance of Wyatt Brewster and Lars (Skip) Skotte is gratefully acknowledged.

The help and cooperation of the Navajo Tribe Office in Window Rock, Arizona permitted a statewide investigation to be completed; a note of thanks goes to Mr. R. Zaman and Mr. William Armstrong of that office.

Quad: Redrock Valley 15'

1. AZ-40-0-1
VCA Plot #7 (Lower Oak Creek)
Page ~~41~~ 42
2. AZ-40-0-2
Franks Point (Plot. 6)
Page ~~53~~ 54
3. AZ-40-0-3
Lower Salt Rock
AZ-40-0-3
Upper Salt Rock
Page ~~56~~ 57
4. AZ-40-0-4
Williams Point (Plot #4)
Page ~~64~~ 65
5. AZ-40-0-5
Salt Canyon Mines (Salt Canyon Claim)
Page ~~68~~ 69
- 6-9. AZ-40-0-6 to 9
VCA Plot #3
Page ~~73~~ 76
10. AZ-40-0-10
Tent (Tent Claim)
Page ~~90~~ 91
11. AZ-40-0-11
Begay Incline
Page ~~93~~ 94
12. AZ-40-0-12
Begay #2
Page ~~97~~ 98
13. AZ-40-0-13
Carrizo #1 (MP-24)
Page ~~100~~ 101
14. AZ-40-0-14
King Tutt Point (VCA Plot #2)
Page ~~104~~ 105
15. AZ-40-0-15
Begay (Begay #1)
Page ~~111~~ 113

- | | | |
|-----|-------------------------------------|-------------------------|
| 16. | AZ-40-0-16 | Page 115 118 |
| | Red Wash Point (VCA Plot #1) | |
| 17. | AZ-40-0-17 | Page 119 122 |
| | King Tutt 1 (MPG) | |
| 18. | AZ-40-0-18 | Page 125 128 |
| | Junction | |
| 19. | AZ-40-0-19 | Page 128 131 |
| | Alongo (Alongo Claim) | |
| 20. | AZ-40-0-20 | Page 131 134 |
| | Canyon View (Alongo Claim) | |
| 21. | AZ-40-0-21 | Page 135 138 |
| | KING Tutt #2 (MP-G Sylvania Mining) | |

REFERENCES FOR CARRIZO MINING DISTRICT

- | | |
|--|-------------------------|
| *Preface to Chuska District Reports | Page 138 141 |
| *Road log to Sanostee Quad. and the Chuska Mining District | Page 141 144 |

Quad: Sanostee West 7½'

- | | | |
|----|------------------------|----------|
| 1. | NM-49-2-1 | Page 148 |
| | Dennet Nezz #1 and #2 | |
| 2. | NM-49-2-2 | Page 150 |
| | Dennet Nezz #3 | |
| 3. | NM-49-2-1001 (unnamed) | Page 151 |
| | (unnamed) Sec. 8 Adit | |

PREFACE TO EAST CARRIZO DISTRICT REPORTS

The East Carrizo District lies along or within several miles of the Arizona border in townships 29 and 30 N., and ranges 20 and 21 west.

The area is covered on the Pastora Peak and Redrock Valley 15' topographic quadrangles, but is largely unsurveyed. A land net was projected in solely to determine if our locations agreed with those given in other publications such as Hilpert, L., (1969), and does not appear on the East Carrizo District claim maps (after AEC, 1953, Claim Maps, East Carrizo District) that accompany each report.

These claim maps were provided for our use on this project by Mr. William Chenoweth of the U.S. Department of Energy, Grand Junction Office, Grand Junction, Colorado. They show access roads, drainage lines, and the claims in the area as of 1953. The only scale they carry is the mile post markers along the New Mexico/Arizona state line.

Orin J. Anderson

*New Mexico Bureau of Mines and Mineral Resources
Socorro, New Mexico
June, 1980*

Date Visited 11/2/80

Mine name(s) Carrizo #1 (MP-24) County San Juan
Section (Unsurveyed) Sec. 24 Twنش. 29 N R. 21 W
Quadrangle sheet Redrock Valley
Mining district East Carrizo
Elevation 5550'
Nearest city and/or dwelling (1) Oak Springs 3 mi. NW (2) single family dwelling 20 mi. S.

The Carrizo #1 is located at the southern end of the plot marked as E. Tapahonso MP-24 (see claim index map). It consists of a single decline which goes down to intersect the Begay #1 workings. It was driven several years after the Begay #1 adit was completed because of a safety problem that developed with the Begay adit.

The entrance is in good condition, well timbered (see Photo a) and is readily entered by a man. Entrance is approx. 6' x 6', decline is about 12°, and length is unknown because of poor lighting but is at least 60'. It may have been tracked as two 16' rails lie just outside on the main dump (see Photo b).

The mine was operated from 1956-1958 by Delmer Spafford and Sons. Host rock is Salt Wash ss. member of Morrison formation; total production was 828 tons of ore averaging .21% U_3O_8 and 1.32% V_2O_5 . The ore contained 3,426 lbs. of U_3O_8 and 21,917 lbs. of V_2O_5 ; U:V ratio approximately 1:4.

An additional photo of the Begay #1 (Photo c) shows the dump, looking NW, with the decline just visible at extreme left photo; Carrizo Mtns. in background. Dump is 4'-7' high, 80' long in E-W direction by 65' in N-S direction. Photo d looks SE into the mine area showing numerous "standpipes" marking drill hole location.

Access roads are shown on attached claim index map.

- References:
- (1) Chenoweth, W.L., 1980,, Historical Review of Uranium-Vanadium in The East Carrizo Mountains, San Juan County, New Mexico, U.S. DOE, TM-210.
 - (2) Hilpert, L., 1969, Uran. Res. of NW New Mexico; U.S.G.S PP. 603, p. 52.
 - (3) East Carrizo District Claim Index Map, 1953.

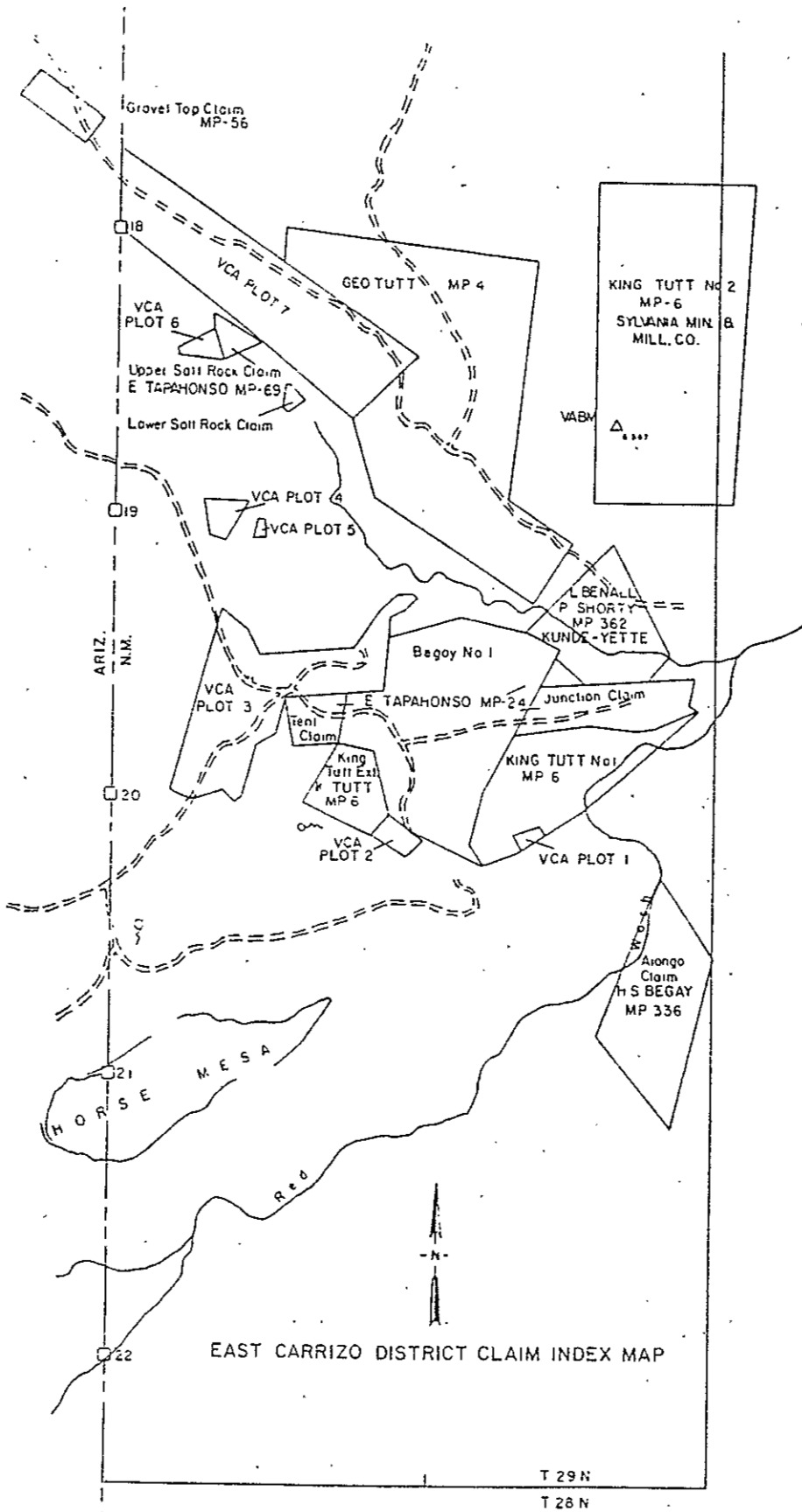



Photo A - Looking west into portal, Carrizo #1 mine; note hammer on heading for scale.



Photo B - Looking south, Carrizo #1 dump; note rails lying on dump at just to right of center; Lukachukai Mtns. in background.

517

SJ-103



Photo C - Looking NW at main dump, Carrizo #1 ; Carrizo Mtns. in background



Photo D - Carrizo area, looking SE; note "standpipes" marking drill hole locations.