



**Environmental Protection Division**  
**Environmental Compliance Programs (ENV-CP)**  
PO Box 1663, K490  
Los Alamos, New Mexico 87545  
(505) 667-0666

**National Nuclear Security Administration**  
**Los Alamos Field Office, A316**  
3747 West Jemez Road  
Los Alamos, New Mexico, 87545  
(505) 667-5794/Fax (505) 667-5948

*Date:* **MAY 05 2015**  
*Symbol:* ENV-DO-15-0103  
*LA-UR:* 15-22567  
*Locates Action No.:* N/A

Mr. John E. Kieling, Bureau Chief  
Hazardous Waste Bureau  
New Mexico Environment Department  
2905 Rodeo Park Drive East, Building 1  
Santa Fe, New Mexico 87505-6303

Dear Mr. Kieling:

**Subject: Transmittal of Class 1 Permit Modification to Update Figures in the Los Alamos National Laboratory (LANL) Hazardous Waste Facility Permit, EPA ID No. NM0890010515**

The purpose of this letter is to submit a Class 1 permit modification to the Los Alamos National Laboratory (LANL) Hazardous Waste Facility Permit issued to the Department of Energy and Los Alamos National Security, LLC (DOE/LANS) in November 2010. The permit modification provides revisions to figures in Permit Attachments G and N.

The proposed modifications have been prepared in accordance with the Code of Federal Regulations [CFR], Title 40 (40 CFR) § 270.42(a)(2) and Permit Section 3.1(3).

This permit modification package includes this transmittal letter and two enclosures. Enclosure 1 contains a description of changes as well as replacement figures for both Attachments N and G of the Permit. Enclosure 2 contains a signed certification page. Three hard copies and one electronic copy of this submittal will be delivered to the New Mexico Environment Department Hazardous Waste Bureau (NMED-HWB). The hardcopy submittal contains replacement figures for Attachments G and N. The electronic copy contains a reproduction of the hardcopy in portable document format (PDF) along with all the word processing files used to create the hardcopy.

Upon approval of this Class 1 permit modification, the modification will be put into effect and notice will be sent to the NMED-HWB maintained LANL facility mailing list in accordance with 40 CFR §270.42(a)(1)(ii) within ninety days of the transmittal of this permit modification.

If you have comments or questions regarding this permit modification, please contact Gene Turner (DOE) at (505) 667-5794 or Mark Haagenstad (LANS) at (505) 665-2014.

Sincerely,



Alison M. Dorries  
Division Leader  
Environmental Protection Division  
Los Alamos National Security LLC

Sincerely,

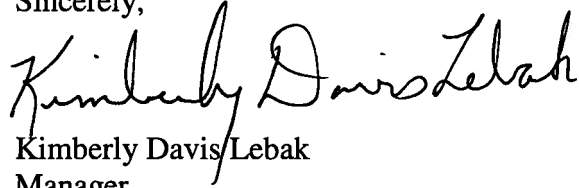

Kimberly Davis Lebak  
Manager  
Los Alamos Field Office  
U.S. Department of Energy

AMD:KDL:MPH:TAD/lm

Enclosures: (1) Description of proposed permit changes and replacement figures for Attachments N and G  
(2) Certifications

Cy: Gene E. Turner, LASO-NS-LP, (E-File)  
Kirsten Laskey, LASO-SUP, (E-File)  
Michael A. Lansing, PADOPS, (E-File)  
Amy E. De Palma, PADOPS, (E-File)  
Michael T. Brandt, ADESH, (E-File)  
Raeanna Sharp-Geiger, ADESH, (E-File)  
Alison M. Dorries, ENV-DO, (E-File)  
Mark Haagenstad, ENV-CP, (E-File)  
Tammy A. Diaz, ENV-CP, (E-File)  
Jeff A. Carmichael, ENV-CP, (E-File)  
Robert Mason, TA55-DO, (E-File)  
Keith A. Lacy, NPI-7, (E-File)  
[lasomailbox@nnsa.doe.gov](mailto:lasomailbox@nnsa.doe.gov), (E-File)  
[locateteam@lanl.gov](mailto:locateteam@lanl.gov), (E-File)  
[env-correspondence@lanl.gov](mailto:env-correspondence@lanl.gov), (E-File)  
[rcra-prr@lanl.gov](mailto:rcra-prr@lanl.gov)

# **ENCLOSURE 1**

**Description of proposed permit changes and replacement  
figures for Attachments N and G**

**ENV-DO-15-0103**

**LA-UR-15-22567**

**Date:           MAY 05 2015**

### **Permit Modification Notification**

This document contains a notification for a Class 1 Permit Modification to the Los Alamos National Laboratory (LANL) Hazardous Waste Facility Permit (Permit) issued to the Department of Energy and the Los Alamos National Security, LLC, collectively known as the Permittees, in November 2010. Replacement figures for Attachments N and G are enclosed as Attachment 1 to this modification.

#### **Description**

The purpose of this modification submittal is to update figures in Attachments N (Figures) and G (Closure Plans) to reflect the movement of TA-55-PF-190 located on the TA-55 Outdoor Pad.

#### **Basis**

This modification has been prepared in accordance with Code of Federal Regulations, Title 40 §270.42 Appendix I, Item A.1, and with Permit Section 3.1(3).

#### **Discussion of Changes**

Attachment N, Figure 45 (Technical Area (TA)-55, Building 4, Outdoor Container Storage Pad and Attachment G.26, Figure G.26-1 (Technical Area 55 Outdoor Container Storage Unit Grid Sampling and Additional Sampling Locations) were revised to relocate structure 55-0190 from the southwest side of the outdoor pad to the southeast side of the outdoor pad.

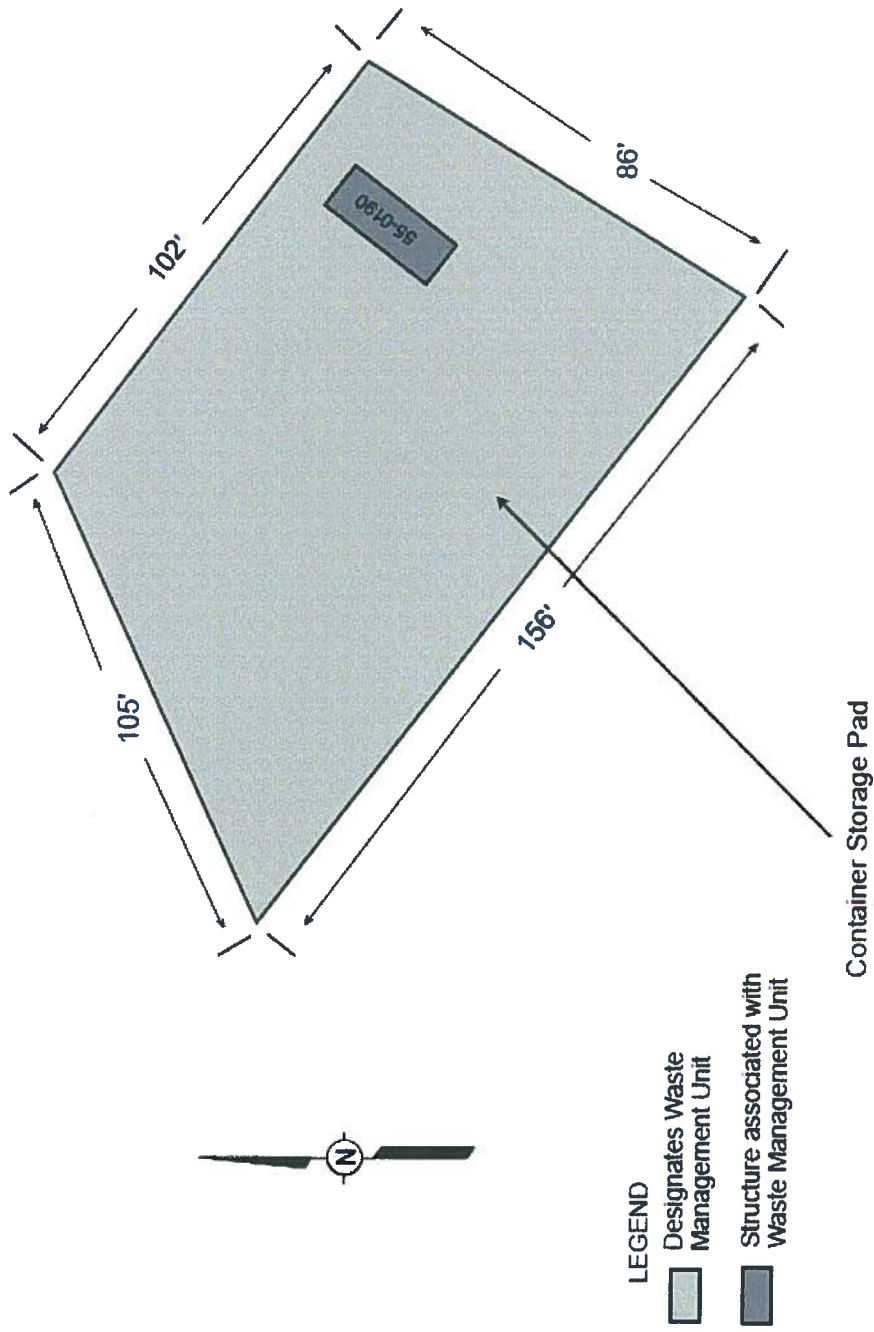

**Note:** TA-55-4 is located approximately 140 feet east of this container storage pad. Refer to Figure 39 for the general location of this container storage pad in relation to other buildings/structures at TA-55.

Figure 45  
 Technical Area (TA)-55, Building 4, Outdoor Container Storage Pad

**Figure G.26-1: Technical Area 55  
Outdoor Storage Pad  
Permitted Unit**

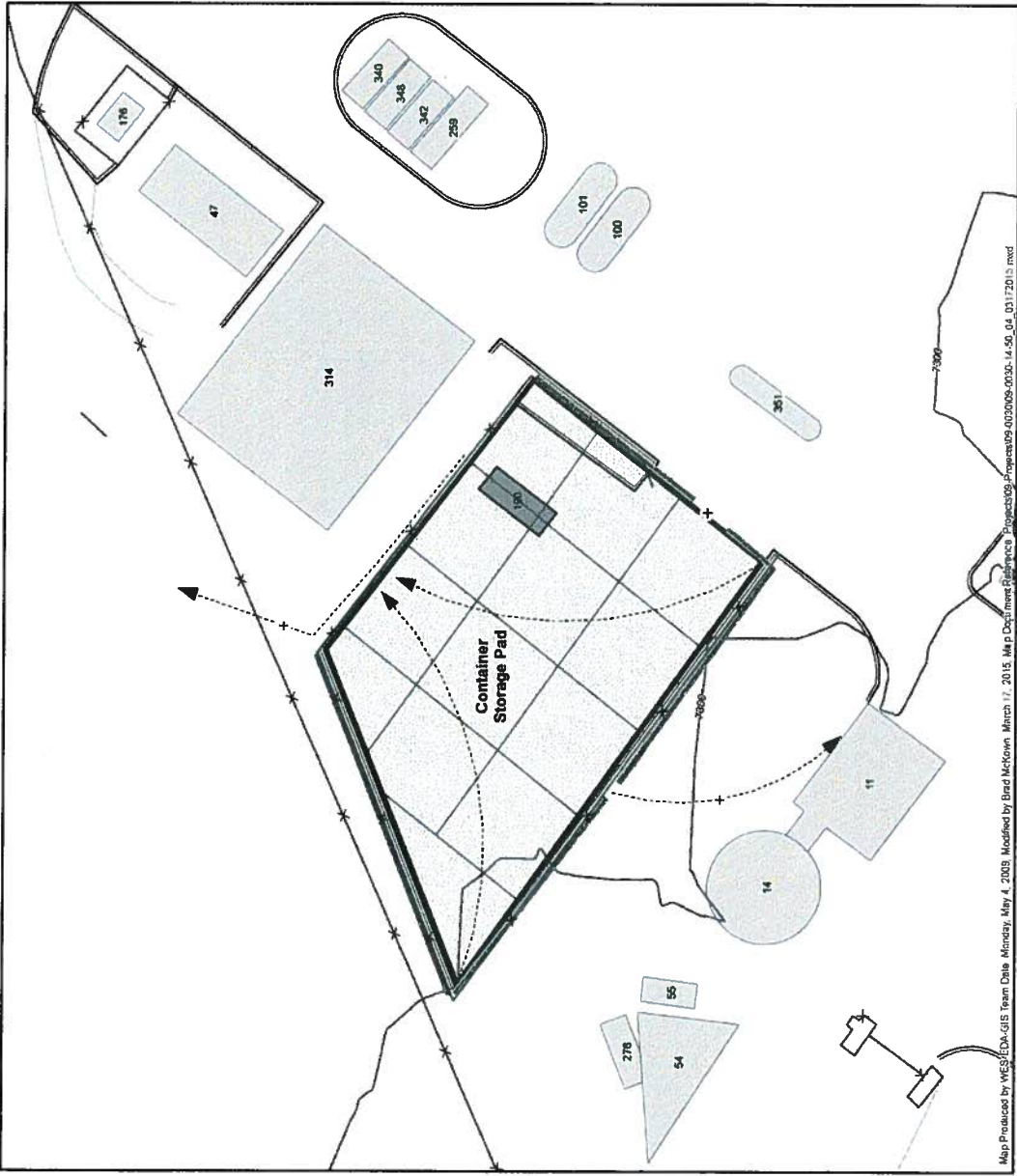

**Legend**

- + Additional Sampling Locations
- Buildings/Structures (not associated with the permitted unit)
- RCRA Waste Management Units (RWMU) Category
- RWMU
- Structure
- Sample grid (cell size = 900 sqft)
- ▬ Berm
- ▬ Drainage
- ▬ Contours, 100 ft
- ▬ Contours, 20 ft
- ▬ Roads, paved
- ▬ Roads, dirt
- ✕ Fences

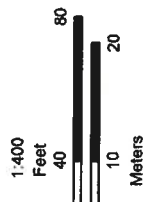

State Plane Coordinate System New Mexico, Central Zone, US Feet  
NAD 1983 Datum

DISCLAIMER: This map was created for work processes associated with the LAM, Hazardous Waste Facility Permit. All other uses for this map should be confirmed with the LAM, ENV Division, Water Quality & RCRA

**Data Sources:**  
 Address Sampling Locations: Project data 09-03-06, TAGS, C:\AddressSampling\shp, 05/04/2009  
 Buildings: Project data 09-03-06, TAGS, C:\AddressSampling\shp, 05/04/2009  
 Sample Grid: Project data 09-03-06, TAGS, C:\AddressSampling\shp, 05/04/2009  
 Address from Project data 09-03-06, TAGS, C:\AddressSampling\shp, 05/04/2009  
 Sample Grid: Project data 09-03-06, TAGS, C:\AddressSampling\shp, 05/04/2009  
 Project Name: 555 PVO, Project Name: 555 PVO, Project Name: 555 PVO  
 100 ft Contours: 555 PVO, Project Name: 555 PVO, Project Name: 555 PVO  
 20 ft Contours: 555 PVO, Project Name: 555 PVO, Project Name: 555 PVO  
 100 ft Contours: 555 PVO, Project Name: 555 PVO, Project Name: 555 PVO  
 20 ft Contours: 555 PVO, Project Name: 555 PVO, Project Name: 555 PVO  
 Structure: 555 PVO, Project Name: 555 PVO, Project Name: 555 PVO  
 Structure: 555 PVO, Project Name: 555 PVO, Project Name: 555 PVO

**Figure G.26-1: Technical Area 55 Outdoor Container Storage Unit Grid Sampling and Additional Sampling Locations.**

# **ENCLOSURE 2**

Certifications

ENV-DO-15-0103

LA-UR-15-22567

Date:           MAY 0 5 2015

**CERTIFICATION**

I certify under penalty of law that this document and all attachments were prepared under my direction or supervision in accordance with a system designed to assure that qualified personnel properly gather and evaluate the information submitted. Based on my inquiry of the person or persons who manage the system, or those persons directly responsible for gathering the information, the information submitted is, to the best of my knowledge and belief, true, accurate, and complete. I am aware that there are significant penalties for submitting false information, including the possibility of fine and imprisonment for knowing violations.



**Alison M. Dorries**  
Division Leader  
Environmental Protection Division  
Los Alamos National Laboratory  
Operator

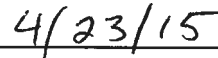

**Date Signed**

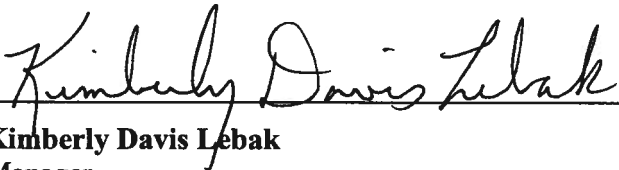

**Kimberly Davis Lebak**  
Manager  
Los Alamos Field Office  
U.S. Department of Energy

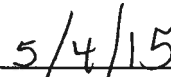

**Date Signed**