

ABANDONED OR INACTIVE URANIUM
MINES IN NEW MEXICO

A report of investigation carried out
between August 1979 and May 1980 under
contract with the New Mexico Energy and
Minerals Department.

by

Orin J. Anderson

New Mexico Bureau of Mines and
Mineral Resources
Open-File Report 148

INTRODUCTION

During the course of this investigation approximately 200 uranium mine sites were visited. Although these sites are distributed throughout 20 counties the majority are in McKinley, San Juan, and Valencia Counties, along the western and southern margin of the San Juan Basin. Other counties with an appreciable number of sites are Grant, Rio Arriba, Sandoval, Sierra, and Socorro.

Field work commenced in August, 1979 and extended although not continuously, into May, 1980. Information obtained during the on-site visits included location, type and size of mine, condition of mine, host formation, dimensions of remaining structures, proximity to residences or villages, water quality data, and radiation levels, although a gamma ray scintillometer was not obtained for the project until October 20, 1979. An effort was made to contact landowners whenever and wherever possible, however, no systematic attempt was made to determine land and mineral ownership during this phase of the investigation.

Mine operation data has been included where available. This consists of information on ore grades, production history mineralogy, and mine operator. Old publications of the U.S. AEC and the State Mine Inspectors office were helpful in this area.

The mine reports are arranged alphabetically by county with each county having its own index. A NM- or AZ-mine identification number is given with each mine name in the index. It is an AML numbering system devised by Don Baker, Jr. The first part of this

identification number is based on a U.S. Soil Conservation Service numbering system of 15' quadrangles beginning with 1 in the northwest corner of the state to 24 in the northeast corner, then returning to the western border to start a new tier. The second part refers to a 7½' quad within the 15' quad; these are numbered counterclockwise from 1 in the NE quadrant to 4 in the SE. The last part of the number refers to a particular mine within the 7½' quad. An AZ- prefix indicates the 15' quadrangle is an Arizona quad that overlaps the New Mexico state boundary.

Acknowledgments - The writer wishes to thank the following people for their valuable assistance in the field: Lars (Skip) Skotte, Richard Chamberlin, JoAnne Osburn, Mary Ann Anderson, and Cheryl Kyllonen.

A special thanks is extended to Mr. William Chenoweth of the U.S. Department of Energy, both for his time in the field as well as the claim maps and A.E.C. mine production records he provided. Mr. John Blagbrough provided helpful information about the Chuska district. The editorial assistance of Wyatt Brewster and Lars (Skip) Skotte is gratefully acknowledged.

The help and cooperation of the Navajo Tribe Office in Window Rock, Arizona permitted a statewide investigation to be completed; a note of thanks goes to Mr. R. Zaman and Mr. William Armstrong of that office.

Quad: Redrock Valley 15'

- | | | |
|------|---------------------------------------|-------------------------|
| 1. | AZ-40-0-1 | Page 41 42 |
| | VCA Plot #7 (Lower Oak Creek) | |
| 2. | AZ-40-0-2 | Page 53 54 |
| | Franks Point (Plot. 6) | |
| 3. | AZ-40-0-3 | Page 56 57 |
| | Lower Salt Rock | |
| | AZ-40-0-3 | Page 60 61 |
| | Upper Salt Rock | |
| 4. | AZ-40-0-4 | Page 64 65 |
| | Williams Point (Plot #4) | |
| 5. | AZ-40-0-5 | Page 68 69 |
| | Salt Canyon Mines (Salt Canyon Claim) | |
| 6-9. | AZ-40-0-6 to 9 | Page 73 76 |
| | VCA Plot #3 | |
| 10. | AZ-40-0-10 | Page 90 91 |
| | Tent (Tent Claim) | |
| 11. | AZ-40-0-11 | Page 93 94 |
| | Begay Incline | |
| 12. | AZ-40-0-12 | Page 97 98 |
| | Begay #2 | |
| 13. | AZ-40-0-13 | Page 100 101 |
| | Carrizo #1 (MP-24) | |
| 14. | AZ-40-0-14 | Page 104 105 |
| | King Tutt Point (VCA Plot #2) | |
| 15. | AZ-40-0-15 | Page 111 113 |
| | Begay (Begay #1) | |

- | | | |
|-----|-------------------------------------|-------------------------|
| 16. | AZ-40-0-16 | Page 115 118 |
| | Red Wash Point (VCA Plot #1) | |
| 17. | AZ-40-0-17 | Page 119 122 |
| | King Tutt 1 (MPG) | |
| 18. | AZ-40-0-18 | Page 125 128 |
| | Junction | |
| 19. | AZ-40-0-19 | Page 128 131 |
| | Alongo (Alongo Claim) | |
| 20. | AZ-40-0-20 | Page 131 134 |
| | Canyon View (Alongo Claim) | |
| 21. | AZ-40-0-21 | Page 135 138 |
| | KING Tutt #2 (MP-G Sylvania Mining) | |

REFERENCES FOR CARRIZO MINING DISTRICT

- | | |
|--|-------------------------|
| *Preface to Chuska District Reports | Page 138 141 |
| *Road log to Sanostee Quad. and the Chuska Mining District | Page 141 144 |

Quad: Sanostee West 7½'

- | | | |
|----|------------------------|----------|
| 1. | NM-49-2-1 | Page 148 |
| | Dennet Nezz #1 and #2 | |
| 2. | NM-49-2-2 | Page 150 |
| | Dennet Nezz #3 | |
| 3. | NM-49-2-1001 (unnamed) | Page 151 |
| | (unnamed) Sec. 8 Adit | |

PREFACE TO EAST CARRIZO DISTRICT REPORTS

The East Carrizo District lies along or within several miles of the Arizona border in townships 29 and 30 N., and ranges 20 and 21 west.

The area is covered on the Pastora Peak and Redrock Valley 15' topographic quadrangles, but is largely unsurveyed. A land net was projected in solely to determine if our locations agreed with those given in other publications such as Hilpert, L., (1969), and does not appear on the East Carrizo District claim maps (after AEC, 1953, Claim Maps, East Carrizo District) that accompany each report.

These claim maps were provided for our use on this project by Mr. William Chenoweth of the U.S. Department of Energy, Grand Junction Office, Grand Junction, Colorado. They show access roads, drainage lines, and the claims in the area as of 1953. The only scale they carry is the mile post markers along the New Mexico/Arizona state line.

Orin J. Anderson

*New Mexico Bureau of Mines and Mineral Resources
Socorro, New Mexico
June, 1980*

Mine name(s) Williams Point (Plot #4) County San JuanSection (Unsurveyed) W $\frac{1}{2}$ Sec. 14 Twنش. 29 N R. 21 WQuadrangle sheet Redrock Valley 15'Mining district East CarrizoElevation 5700'Nearest city and/or dwelling Oak Springs; 1 $\frac{1}{2}$ mi. N.W.

The Williams Point Mine is located on VCA Plot #4 which lies 1/2 mi. due east of state line mile post #19 (see claim index map). The mine consists of a 32' x 28' box cut up to 6' deep with several scattered small cuts and pits in the surrounding area. Photos (a) and (b) offer views of the box cut looking eastward into the abrupt drop off just east of the mine.

Photo (c) is a view of the hand stacked waste rock just east of the cut, and photo (d) is looking northward at the major portion of the tailings that extends 100' down slope east of the box cut.

Access is provided by a road leading northward from Plot #3 as is shown on the claim index map, it is still passable. The road continues northwestward from Plot #4, crosses the state line and intersects the Oak Spring-Redrock road 1.1 mi. south of Oak Spring.

Some yellow to greenish yellow uranium mineralized was noted (carnotite/tyuyamunite) but occurrences are spotty; no high grade mineralization apparent. Host rock is the Salt Wash member of the Morrison fm.

The mine was operated briefly during the early 1950's and the minor production was reported with the East Reservation lease production figures. Other deposits in the section exhibited U:V ratios of 1:6-1:9 with U₃O₈ grades of .18%-.27%.

- References: (1) Chenoweth, W.L., 1980, Historical Review of Uranium-Vanadium in The Eastern Carrizo Mountains, San Juan County, New Mexico U.S. DOE, TM-210.
- (2) Coleman, A.H., 1944, A Report on The Geology and Ore Deposits of The Beclabito District, Carrizo Up Lift Area, Arizona; RMO-469.
- (3) East Carrizo District Claim Index Map, 1953.

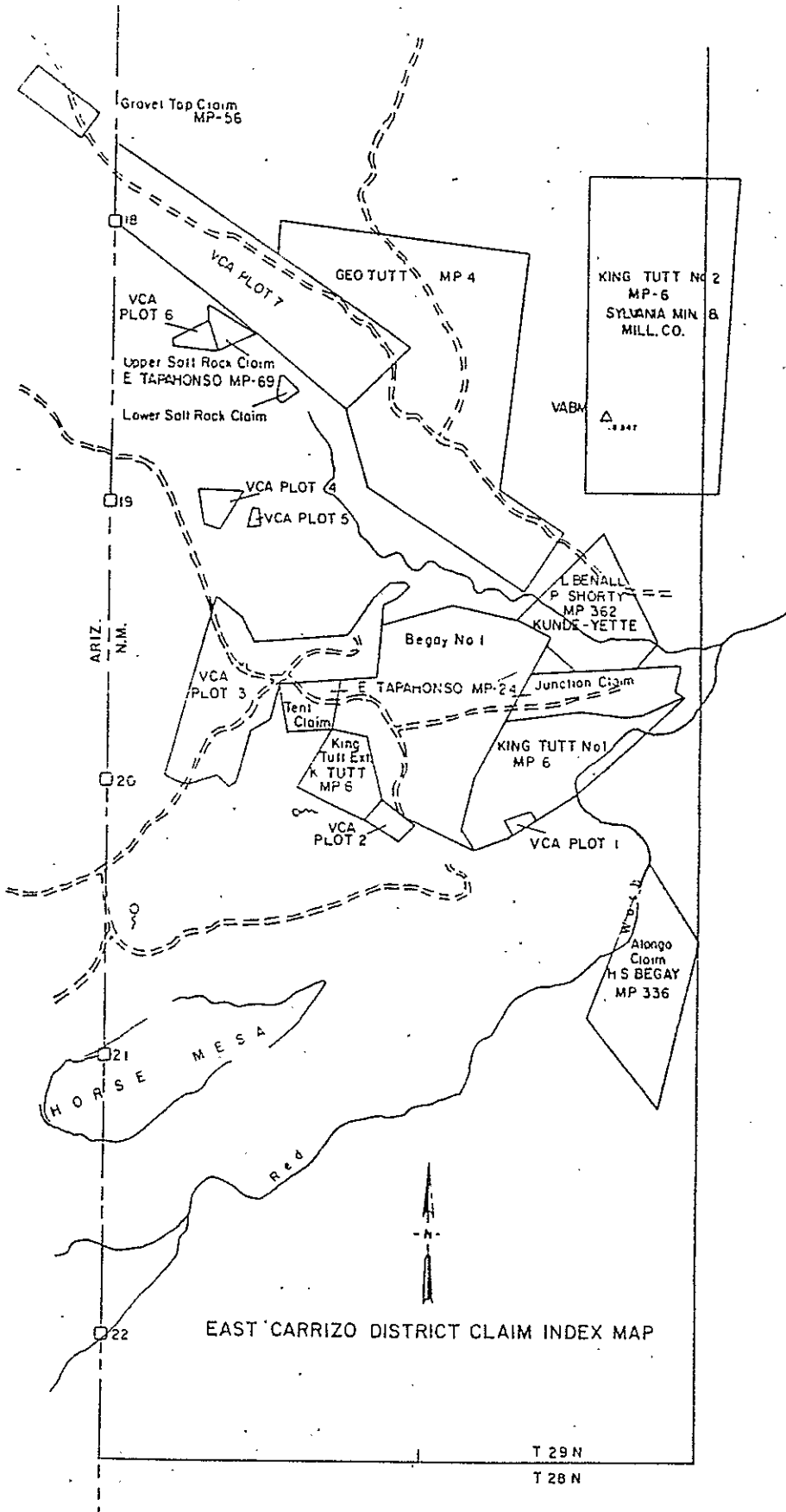



Photo (a) Williams Point mine; looking east at small box cut.

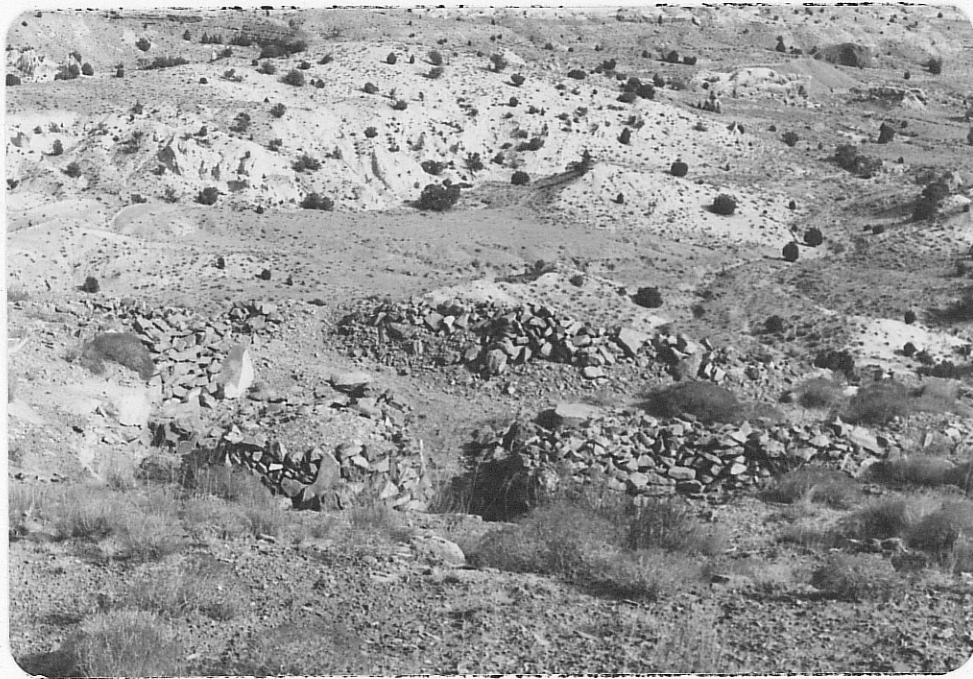

Photo (b) Williams Point mine; looking east; small trench in foreground up to 6' deep.



Photo (c) Williams Point mine; looking N at "stacked" waste rock characteristic of hand labor operations.



Photo (d) Williams Point mine; looking N at main tailings dump extending down slope from box cut.